

MAGNETIC SENSOR SYSTEMS

Tubular Low Profile Clapper Solenoid

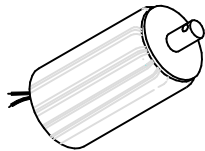

Series S-08-54
0.54" DIA X 0.83"

TOTAL WEIGHT: 0.54 OUNCES
PLUNGER WEIGHT: 0.07 OUNCES
CAPTIVE PLUNGER

duty cycle	1	1/2	1/4	1/10
maximum "ON" time, (Sec.)	∞	100	20	4
watts	3.3	6.5	13.0	32.5
approximate ampere turns	375	530	750	1180

AWG number	resistance	volts DC	volts DC	volts DC	volts DC
25	0.4	1.2	1.6	2.3	3.6
26	0.6	1.4	2.0	2.9	4.6
27	1.2	1.9	2.7	3.9	6.1
28	1.7	2.4	3.5	4.9	7.7
29	3.2	3.2	4.6	6.5	10.2
30	5.5	4.1	5.8	8.2	13.0
31	7.1	4.7	6.7	9.4	14.9
32	11.6	6.2	8.8	12.4	19.6
33	19.5	7.9	11.1	15.7	24.8
34	32.2	10.0	14.2	20.1	31.7
35	51.1	12.8	18.2	25.7	40.6
36	82.0	16.6	23.4	33.2	52.4
37	115	19.1	27.0	38.2	60.4
38	176	24.4	34.5	48.8	77.0
39	290	31.1	44.0	62.2	98.2
40	464	39.6	56.1	79.3	125
41	739	48.1	68.0	96.2	152
42	1116	60.9	86.2	121	193

HEAT SINK: For proper heat dissipation, body of solenoid should be mounted on an equivalent of 2.0" x 2.0" x 1/8" aluminum plate in an unrestricted flow of air.

MAGNETIC SENSOR SYSTEMS

S-08-54

MECHANICAL DIMENSIONS

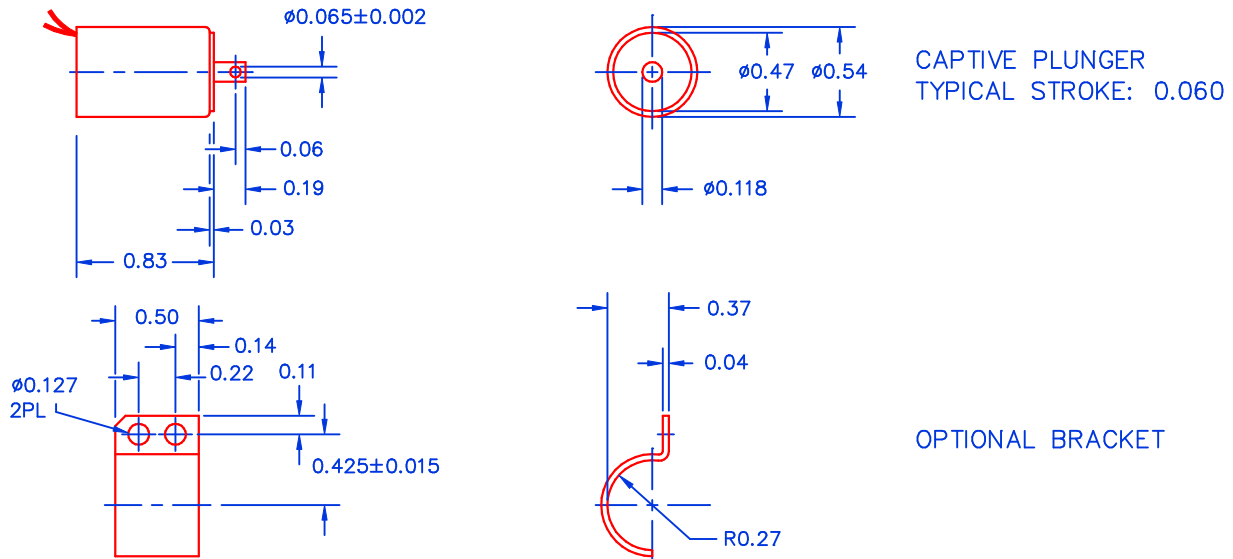

TOLERANCES: (UNLESS NOTED)

.XXX: ±.005

.XX : ±.010

X/X: ± 1/64

COIL RESISTANCE: ±10%

SOLENOID SHOWN ENERGIZED

TYPICAL PULL FORCE VERSUS STROKE

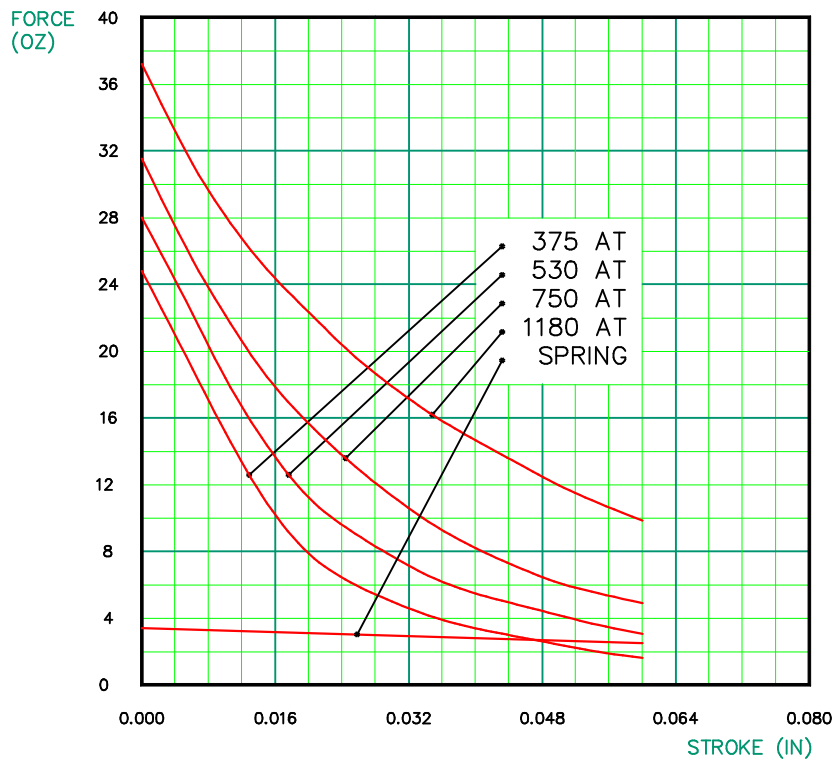

These force curves do not account for return spring.

The typical return spring force is 2.5 / 3.5 OZ as shown.